

## Geberit Kombifix element for bidet, universal

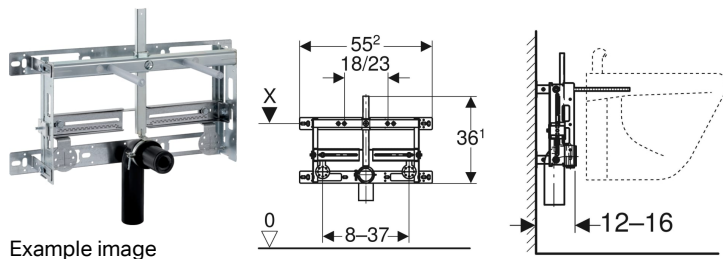

### Application purposes

- For masonry walls
- For installation in part or room-height prewall installations

### Characteristics

- Zinc-plated installation frame
- Mounting frame with four fastening brackets
- Adjustable installation depth, 12–16 cm

### Scope of delivery

- Connection bend made of PE-HD,  $\varnothing$  50 mm
- Seal  $\varnothing$  44 / 32 mm

- Fastening distance for wall-hung bidet 18 or 23 cm
- Height-adjustable bidet fastening
- Fastening for connection bend, height-adjustable and sound-absorbing
- Tap attachments adjustable in width and height

### Technical data

Product material | Steel

- 2 threaded rods M12
- Fastening material

### Art. no.

457.893.00.1

### Accessories

- Geberit elbow tap connector 90° with male thread MF 1/2"