

Geberit Duofix element for bidet, 112 cm, universal

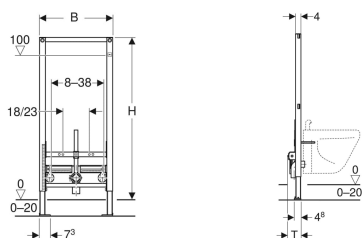

Example image



Application purposes

- For drywall construction
- For installation in part or room-height prewall installations
- For installation in room-height installation walls
- For installation in part or room-height Geberit Duofix system walls
- For wall-hung bidets with deck-mounted tap
- For floor constructions 0–20 cm

Characteristics

- Self-supporting frame, powder-coated
- Frame with \varnothing 9 mm drilling holes for fastening in wood frame construction
- Galvanized feet

Scope of delivery

- Connection bend made of PE-HD, \varnothing 50 mm
- Seal \varnothing 44 / 32 mm

- Feet adjustable 0–20 cm
- Non-slip leg supports
- Rotatable foot plates
- Foot plate depth suitable for installation in U-profiles UW 50 and UW75 and Geberit Duofix system rails
- Fastening distance for wall-hung bidet 18 or 23 cm
- Height-adjustable bidet fastening
- Fastening for connection bend, height-adjustable and sound-absorbing
- Tap attachments adjustable in width and height

Technical data

Product material | Steel

- 2 threaded rods M12
- Fastening material

Art. no.	B	H	T
111.520.00.1	50 cm	112 cm	10 cm